



Document No.	DOC-009-0028
Title	EXTERNAL PIPE DIMENSIONAL CHECK PHOTOGRAPHIC EVIDENCE REPORT
Revision:	A

Report Template Revision	Date	Prepared by	Reviewed by	Approved by
-	11/5/2023	Ethan Anderson	Nidhi Shah	Jesse Lundy
Revision Comments: Initial Release				
A	1/19/2024	Ethan Anderson	Nidhi Shah	Jesse Lundy
Revision Comments: Updated revisions of CS10680, CU11950, formatting.				

This page is for revision history and approval of the report template only and does signify acceptance of specific tank tests.

Ethan Anderson (Jan 22, 2024 09:58 CST)

Drafter Ethan Anderson Engineer Date

r

Nidhi Shah (Jan 22, 2024 11:32 EST)

Reviewer Nidhi Shah Responsible Charge Date

Jesse Lundy (Jan 22, 2024 10:34 CST)

Approver Jesse Lundy Quality Control Manager Date

NOTICE: THIS DOCUMENT EMBODIES CONFIDENTIAL PROPRIETARY INFORMATION OWNED BY APPLIED CRYO TECHNOLOGIES. NOTICE IS HEREBY GIVEN THAT ALL DESIGN, MANUFACTURING, REPRODUCTION, USE AND SALES RIGHTS REGARDING THE SAME ARE EXPRESSLY RESERVED TO APPLIED CRYO TECHNOLOGIES. THIS DOCUMENT IS SUBMITTED UNDER A CONFIDENTIAL RELATIONSHIP FOR A SPECIFIC PURPOSE AND THE RECIPIENT HEREOF BY ACCEPTING THIS DOCUMENT ASSUMES CUSTODY HEREOF AND AGREES NOT TO DISCLOSE THIS DOCUMENT OR ANY PORTION OF ITS CONTENTS TO ANY UNAUTHORIZED PERSON.



Document No.	DOC-009-0028
Title	EXTERNAL PIPE DIMENSIONAL CHECK PHOTOGRAPHIC EVIDENCE REPORT
Revision:	A

TABLE OF CONTENTS

1	PURPOSE	3
2	TEST SPECIFIC INFORMATION.....	3
3	RESULT OF TEST	3
4	LIST OF RELEVANT DRAWINGS	4
5	CS10680-PIP EXTERNAL PIPING & INSTRUMENTATION DIAGRAM, LH2-168-175-P-H	5
6	CU11959 REVA; ASSEMBLY, EXTERNAL PIPE INSTALLATION, FIXED/FLEX END.....	6
7	DIMENSIONAL CHECKS.....	8
8	PHOTOGRAPHIC EVIDENCE OF THE INSPECTION	16



NOTICE: THIS DOCUMENT EMBODIES CONFIDENTIAL PROPRIETARY INFORMATION OWNED BY APPLIED CRYO TECHNOLOGIES. NOTICE IS HEREBY GIVEN THAT ALL DESIGN, MANUFACTURING, REPRODUCTION, USE AND SALES RIGHTS REGARDING THE SAME ARE EXPRESSLY RESERVED TO APPLIED CRYO TECHNOLOGIES. THIS DOCUMENT IS SUBMITTED UNDER A CONFIDENTIAL RELATIONSHIP FOR A SPECIFIC PURPOSE AND THE RECIPIENT HEREOF BY ACCEPTING THIS DOCUMENT ASSUMES CUSTODY HEREOF AND AGREES NOT TO DISCLOSE THIS DOCUMENT OR ANY PORTION OF ITS CONTENTS TO ANY UNAUTHORIZED PERSON.



Document No.	DOC-009-0028
Title	EXTERNAL PIPE DIMENSIONAL CHECK PHOTOGRAPHIC EVIDENCE REPORT
Revision:	A

1 PURPOSE

The purpose of this inspection report is to provide photographic evidence of the external vacuum insulated pipe (VIP) dimension checks.

2 TEST SPECIFIC INFORMATION

CUSTOMER:	SK PLUG HYVERSE
INSPECTOR:	Edgar Rodriguez
DATE INSPECTED:	8/15/24
TANK MODEL:	LH2-168-150-P-H
TANK SERIAL NUMBER:	LH2HT-168013

3 RESULT OF TEST

PASS	X
FAIL	

Inspector Edgar Rodriguez Lead Quality Technician Date

Jesse Lundy (Aug 31, 2024 17:54 CDT)

Approver Jesse Lundy Quality Control Manager Date

Jeonghan Yun (Sep 1, 2024 07:55 GMT+9)

Customer Review Date

Jung Hae Song (Aug 31, 2024 17:56 CDT)

Jun-gyu Lee (Sep 1, 2024 07:57 GMT+9)

KGS Review KGS Inspector Date

NOTICE: THIS DOCUMENT EMBODIES CONFIDENTIAL PROPRIETARY INFORMATION OWNED BY APPLIED CRYO TECHNOLOGIES. NOTICE IS HEREBY GIVEN THAT ALL DESIGN, MANUFACTURING, REPRODUCTION, USE AND SALES RIGHTS REGARDING THE SAME ARE EXPRESSLY RESERVED TO APPLIED CRYO TECHNOLOGIES. THIS DOCUMENT IS SUBMITTED UNDER A CONFIDENTIAL RELATIONSHIP FOR A SPECIFIC PURPOSE AND THE RECIPIENT HEREOF BY ACCEPTING THIS DOCUMENT ASSUMES CUSTODY HEREOF AND AGREES NOT TO DISCLOSE THIS DOCUMENT OR ANY PORTION OF ITS CONTENTS TO ANY UNAUTHORIZED PERSON.



Document No.	DOC-009-0028
Title	EXTERNAL PIPE DIMENSIONAL CHECK PHOTOGRAPHIC EVIDENCE REPORT
Revision:	A

4 LIST OF RELEVANT DRAWINGS

DRAWING #	REVISION	FUNCTIONAL DESCRIPTION	P&ID LINE #	CU11959 ITEM #
CS10680-PIP	J	EXTERNAL PIPING & INSTRUMENTATION DIAGRAM, LH2-168-150-P-H		
CU11959	A	ASSEMBLY, EXTERNAL PIPING INSTALLATION, FIXED/FLEX END		
CU11944	A	1-1/2" PUMP A LIQUID, FIXED END	073	3
CU11945	A	1-1/2" PUMP A RETURN, FIXED END	028	4
CU11946	A	1-1/2" PUMP B LIQUID, FIXED END	030	5
CU11947	A	1-1/2" PUMP B RETURN, FIXED END	031	6
CU11949	B	1-1/2" TOP FILL, FIXED END	002	8
CU11950	A	1" HP PUMP RETURN, FIXED END	001	9
CU11954	-	1" PB FEED, FLEX END	070	12

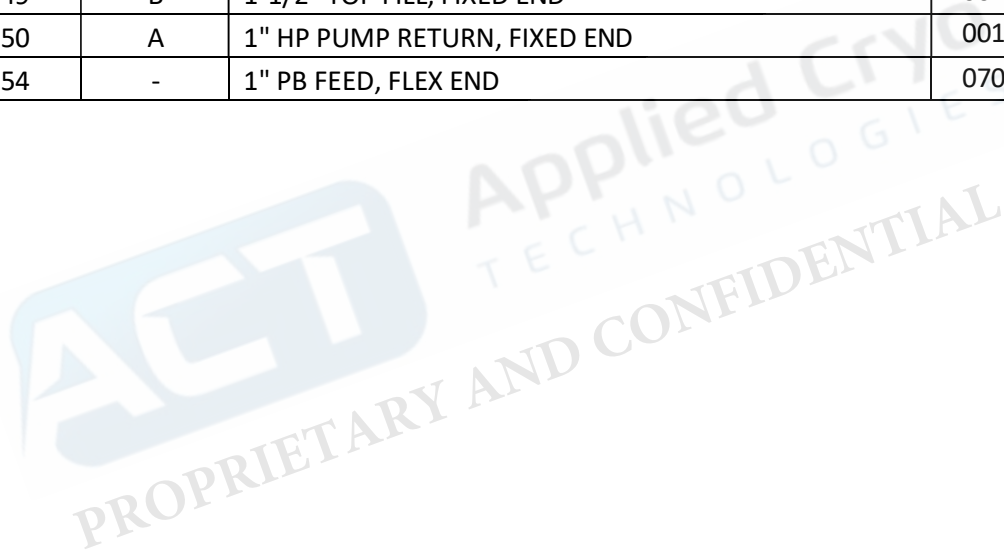

NOTICE: THIS DOCUMENT EMBODIES CONFIDENTIAL PROPRIETARY INFORMATION OWNED BY APPLIED CRYO TECHNOLOGIES. NOTICE IS HEREBY GIVEN THAT ALL DESIGN, MANUFACTURING, REPRODUCTION, USE AND SALES RIGHTS REGARDING THE SAME ARE EXPRESSLY RESERVED TO APPLIED CRYO TECHNOLOGIES. THIS DOCUMENT IS SUBMITTED UNDER A CONFIDENTIAL RELATIONSHIP FOR A SPECIFIC PURPOSE AND THE RECIPIENT HEREOF BY ACCEPTING THIS DOCUMENT ASSUMES CUSTODY HEREOF AND AGREES NOT TO DISCLOSE THIS DOCUMENT OR ANY PORTION OF ITS CONTENTS TO ANY UNAUTHORIZED PERSON.

5 CS10680-PIP EXTERNAL PIPING & INSTRUMENTATION DIAGRAM, LH2-168-175-P-H

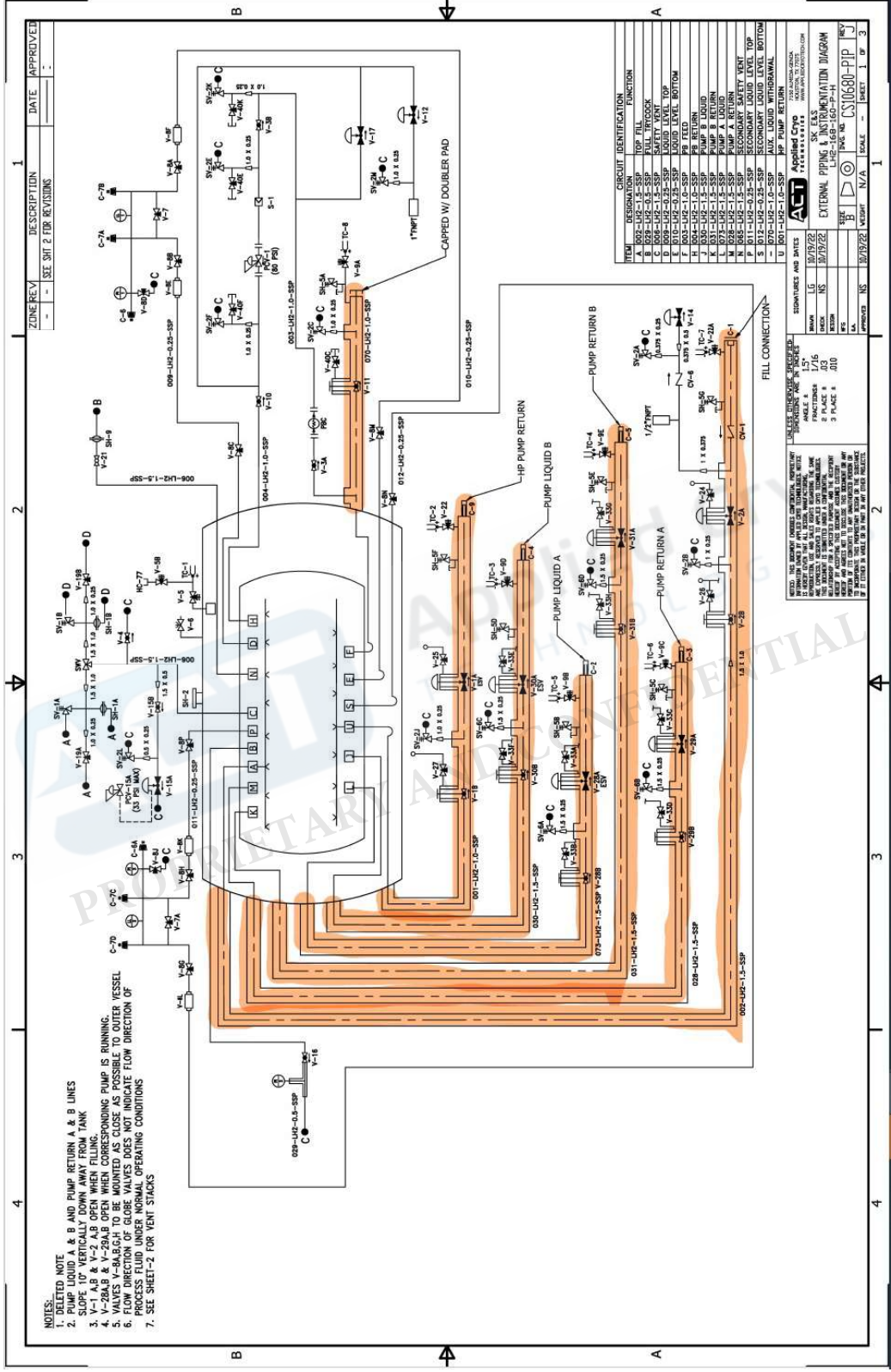

6 CUI1959 REVA: ASSEMBLY, EXTERNAL PIPIG INSTALLATION, FIXED/FLEX END

ZONE	REV	DESCRIPTION	DATE	APPROVED
A	1	UPDATED PICTORALLY, NOTES AND TITLE BLOCK	11/1/2023	C. RODRIGUEZ

REVISION HISTORY	DESCRIPTION	DATE	APPROVED
A	UPDATED PICTORALLY, NOTES AND TITLE BLOCK	11/1/2023	C. RODRIGUEZ

ZONE	REV	DESCRIPTION	DATE	APPROVED
A	1	UPDATED PICTORALLY, NOTES AND TITLE BLOCK	11/1/2023	C. RODRIGUEZ

NOTES:

- REFER TO SCHEMATIC FOR ACTUAL EQUIPMENT AND FITTINGS.
- DIMENSIONS ARE TO CENTER OF VALVE.
- ALL PIPE CONNECTIONS & ATTACHMENTS ARE FULL PENETRATION BUTTWELDS, UNLESS OTHERWISE SPECIFIED
- ALL PIPING JOINTS MUST BE PNEUMATICALLY PRESSURE TESTED TO 1.25 TIMES MAWP OF THE VESSEL PER FP271.
- ALL THREADED PIPE TO BE SCH 80
- 1/4" WEEP HOLE TO BE DRILLED AT EACH LOW POINT IN THE VENT SYSTEM TO DRAIN ANY MOISTURE
- ALL VALVE HANDLES TO HAVE A MINIMUM CLEARANCE OF 3" FROM ANY OBSTRUCTION
- PIPING SHALL BE CLEANED FOR OXYGEN SERVICE PER CGA 4.1
- VISUAL INSPECTION REQUIRED PER ASME B31.3 AND B31.12
- ALL WELDS SHALL UNDERGO DYE PEN TEST
- ALL PIPING MANUFACTURED AND TESTED PER ASME B31.3 AND B31.12: WELD MAP TO RECORD HEAT

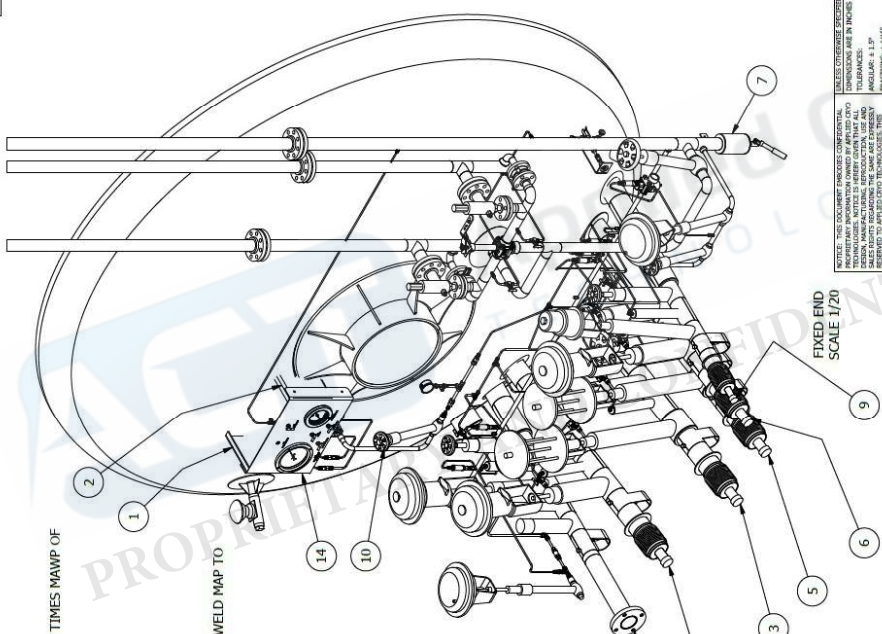

ITEM NO.	SIZE	PART NUM.	QTY.	DESCRIPTION
14		CU19423	2	ASSEMBLY, GAUGE PANEL
13		CU11955	1	1-1/2 SECONDARY SAFETY VENT, FLEX END
12		CU11954	1	1 PR FEED, FLEX END
11		CU11953	1	1 PR RETURN, FLEX END
10		CU11951	1	1/2 FULL TRYCOCK, FIXED END
9		CU11950	1	1 HP PUMP RETURN, FIXED END
8		CU11949	1	1-1/2 TOP FILL, FIXED END
7		CU11948	1	1-1/2 SAFETY VENT, FIXED END
6		CU11947	1	1-1/2 PUMP B RETURN, FIXED END
5		CU11946	1	1-1/2 PUMP B LIQUID, FIXED END
4		CU11945	1	1-1/2 PUMP A RETURN, FIXED END
3		CU11944	1	1-1/2 PUMP A LIQUID, FIXED END
2		CG20106	2	GAUGE PANEL MOUNTING PLATE, CURSIDE
1		CG20105	2	GAUGE PANEL MOUNTING PLATE, ROADSIDE

ITEM NO.	SIZE	PART NUM.	QTY.	DESCRIPTION
1		CG20106	2	GAUGE PANEL MOUNTING PLATE, CURSIDE
2		CG20105	2	GAUGE PANEL MOUNTING PLATE, ROADSIDE

NOTE: THIS DOCUMENT EMBODIES CONFIDENTIAL PROPRIETARY INFORMATION OWNED BY APPLIED CRYO TECHNOLOGIES. NOTICE IS HEREBY GIVEN THAT ALL DESIGN, MANUFACTURING, REPRODUCTION, USE AND SALES RIGHTS REGARDING THE SAME ARE EXPRESSLY RESERVED TO APPLIED CRYO TECHNOLOGIES. THIS DOCUMENT IS SUBMITTED UNDER A CONFIDENTIAL RELATIONSHIP FOR A SPECIFIC PURPOSE AND THE RECIPIENT HEREOF BY ACCEPTING THIS DOCUMENT ASSUMES CUSTODY HEREOF AND AGREES NOT TO DISCLOSE THIS DOCUMENT OR ANY PORTION OF ITS CONTENTS TO ANY UNAUTHORIZED PERSON.

UNLESS OTHERWISE SPECIFIED, DIMENSIONS ARE IN INCHES
 UNLESS OTHERWISE SPECIFIED, DIMENSIONS ARE IN MILLIMETERS
 UNLESS OTHERWISE SPECIFIED, DIMENSIONS ARE IN INCHES
 UNLESS OTHERWISE SPECIFIED, DIMENSIONS ARE IN MILLIMETERS
 UNLESS OTHERWISE SPECIFIED, DIMENSIONS ARE IN INCHES
 UNLESS OTHERWISE SPECIFIED, DIMENSIONS ARE IN MILLIMETERS

APPLIED CRYO TECHNOLOGIES
 15600 GEORGE LUTZ STORAGE TANK
 SCALE 1/20
 SHEET 1 OF 4

SEE NOTES ON SHEET 1

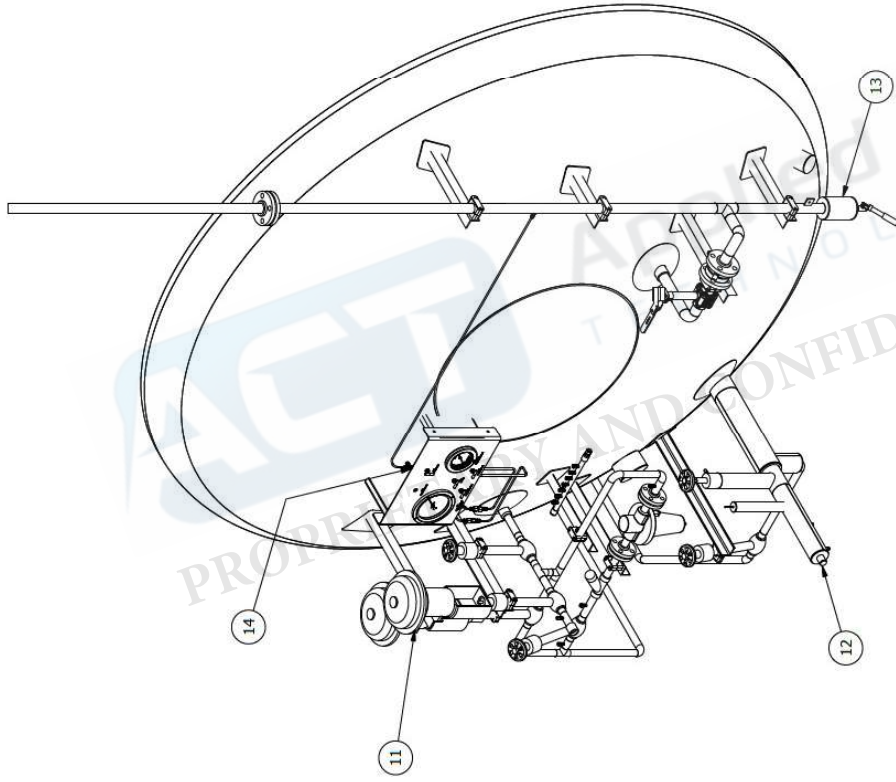

FLEX END
SCALE 1/20

<p>NOTICE: THIS DOCUMENT EMBODIES CONFIDENTIAL PROPRIETARY INFORMATION OWNED BY APPLIED CRYO TECHNOLOGIES. NOTICE IS HEREBY GIVEN THAT ALL DESIGN, MANUFACTURING, REPRODUCTION, USE AND SALES RIGHTS REGARDING THE SAME ARE EXPRESSLY RESERVED TO APPLIED CRYO TECHNOLOGIES. THIS DOCUMENT IS SUBMITTED UNDER A CONFIDENTIAL RELATIONSHIP FOR A SPECIFIC PURPOSE AND THE RECIPIENT HEREOF BY ACCEPTING THIS DOCUMENT ASSUMES CUSTODY HEREOF AND AGREES NOT TO DISCLOSE THIS DOCUMENT OR ANY PORTION OF ITS CONTENTS TO ANY UNAUTHORIZED PERSON.</p>	
<p>UNLESS OTHERWISE SPECIFIED, DIMENSIONS ARE IN INCHES. TOLERANCES ARE IN INCHES: ANGULAR: ± 1.0° HOLE POSITION: ± 0.010" TWO PLACE DECIMAL: ± 0.020" THREE PLACE DECIMAL: ± 0.007"</p>	<p>DATE: 9/7/2023 CHECKED: N. SHAH DESIGNED: N. SHAH DRAWN: N. SHAH MATERIAL: 16.8K 160psi LH2 STORAGE TANK TANKING: CU11959 SCALE: 1/20 SHEET: 3 OF 4</p>
<p>APPLIED CRYO TECHNOLOGIES 1100 ALAMOSA AVENUE HOUSTON, TX 77058 WWW.APPLIEDCRYO.COM</p>	<p>ASSEMBLY, EXTERNAL PIPING INSTALLATION, FIXED/FLEX END</p>

1 2 3 4

7 DIMENSIONAL CHECKS

SPOOL DRAWING NUMBER: CU11944 REV A 1-1/2" PUMP A LIQUID, FIXED END
 P&ID LINE #: 073
 CU11959 ITEM #: 3

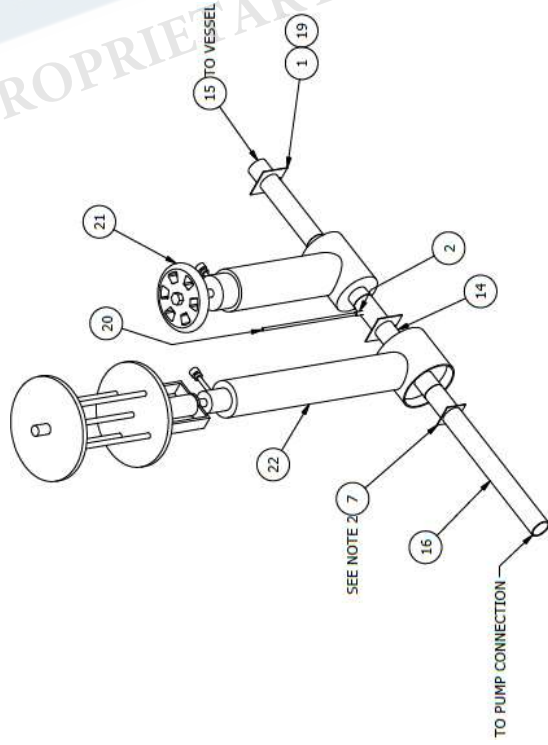

ITEM NO.	QTY	DESCRIPTION
23	-	1 VALVE, VACUUM, SEAL-OFF, 1/2"
22	-	1 VALVE, GLOBE, V-EXT STEM, 1.5 IN. SS, BW, ACTUATED, VOGT W/ESV AIGS
21	-	1 VALVE, BELLOWS, V-EXT STEM, 1.5 IN. SS, BW, MANUAL
20	-	1 TUBE, ROUND, SS, 1/4 O.D. X 0.049 WALL, CUT TO 8 LG, SA312, TP316/316L, SMLS
19	-	AIR TIE WIRE, 0.02 OD
18	-	1 TANK FIELD JOINT, 1.5 X 4 X 8 IN. CL426
17	-	AIR STRING, MULTI-END CONTINUOUS WELDING, ME3021
16	-	1 PIPE, SS, 1-1/2 SCH 10, CUT TO 18-1/4 LG, SEAMLESS, SA312-316
15	-	1 PIPE, SS, 1-1/2 SCH 10, CUT TO 10 LG, SEAMLESS, SA312-316
14	-	1 PIPE, SS, 1-1/2 SCH 10, CUT TO 5-1/2 LG, SEAMLESS, SA312-316
13	-	1 NURPLE, HAUF, T.O.E.P., SS, 0.125 WPT SCH 80 X 1.5 LG, SA312, TP304
12	-	AIR CRYO-LITE, FIBERGLASS BLANKET, 1 THICK
11	-	1 TC TUBE GUARD
10	-	- DELETED ITEM
9	-	2 WELD ADAPTER, 4" IPS X 5" SCH5
8	-	1 SPLIT JACKET LIQUID VAPOR HORIZONTAL
7	-	1 SPACER, 1-1/2" IPS X 3" SCH 5
6	-	1 SPLIT JACKET PUMP/LIQUID SEAL OFF
5	-	1 JACKET, STAND-OFF, SAFETY
4	-	1 WELD ADAPTER, 1-3/4" O.D. X 3/8" SCH 5
3	-	1 SPLIT JACKET ALX, VAPOR HORIZONTAL
2	-	1 ADAPTER, INNER LINE RELIEF
1	-	2 SPACER, 1-1/2" IPS X 4" SCH 5
ITEM NO.	QTY	DESCRIPTION
ITEM NO.	QTY	DESCRIPTION

DIMENSIONAL CHECK			
ITEM#	DESIGN (IN)	ACTUAL (IN)	RESULT
14	5-1/2	5-1/2	Pass
15	10	15	Pass
16	18-1/4	18-1/4	Pass
TOTAL (Reference)	48-3/16	55	Pass
NOTES			

INSPECTED BY:
 Robert Guajardo
 DATE: 8/15/2024

VERIFIED BY:
 Edgar Rodriguez
 DATE: 8/15/2024

SPOOL DRAWING NUMBER: CU11945 REV A 1-1/2" PUMP A RETURN, FIXED END

P&ID LINE #: 028

CU11959 ITEM #: 4

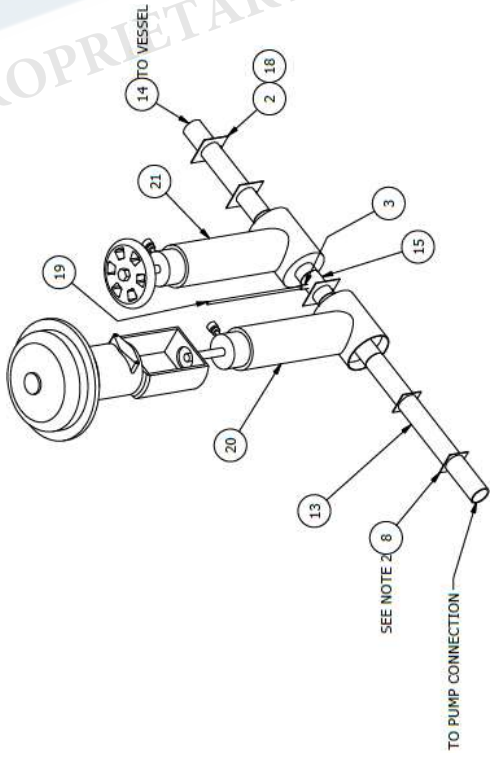

ITEM#	DESCRIPTION	QTY.
22	1 VALVE, VACUUM, SEAL-OFF, 1/2"	1
21	1 VALVE, BELLOWS, VI EXT STEM, 1.5 IN. SS, B/W, MANUAL	1
20	1 VALVE, BELLOWS, VI EXT STEM, 1.5 IN. SS, B/W, ACTUATED	1
19	1 TUBE, ROUND, SS, 1/4 O.D. X 0.049 WALL, CUT TO 12 LG. SA213, TP316/316L, SHLS	1
18	AIR TIE WIRE, 0.02 OD	1
17	1 TANK FIELD JOINT, 1.5 X 4 X 6 IN. CL486	1
16	AIR STRINGS, MULTI-END CONTINUOUS GROOVING, ME3021	1
15	1 PIPE, SS, 1-1/2 SCH 10, CUT TO 3 LG. SEAMLESS, SA312-316	1
14	1 PIPE, SS, 1-1/2 SCH 10, CUT TO 12 LG. SEAMLESS, SA312-316	1
13	1 PIPE, SS, 1-1/2 SCH 10, CUT TO 18 LG. SEAMLESS, SA312-316	1
12	1 NIPPLE, HALF, T.O.E., SS, 0.125 NPT SCH 80 X 1.5 LG. SA312, TP304	1
11	AIR CRYO-LITE, FIBERGLASS BLANKET, 1 THICK	1
10	1 TC TUBE GUARD	1
9	1 SPLIT JACKET LIQUID VAPOR HORIZONTAL	1
8	2 SPACER, 1-1/2" IPS X 3" SCH 5	2
7	1 SPLIT JACKET PUMP LIQUID SEAL OFF	1
6	1 JACKET, STANDOFF, SAFETY	1
5	1 SPLIT JACKET, PUMP HORIZONTAL	1
4	1 WELD ADAPTER, 1-3/4" O.D. X 3/8" SCH 5	1
3	1 ADAPTER, INNER LINE RELIEF	1
2	4 SPACER, 1-1/2" IPS X 4" SCH 5	4
1	- DELETED ITEM	-
ITEM#	DESCRIPTION	QTY.
NO. SIZE	PART NUM.	

ITEM#	DIMENSIONAL CHECK		RESULT
	DESIGN (IN)	ACTUAL (IN)	
13	18	18	Pass
14	12	17-1/8	Pass
15	3	3-1/8	Pass
TOTAL (Reference)	49	54-1/4	Pass
NOTES			

INSPECTED BY:
Robert Guajardo

DATE: 8/15/2024

VERIFIED BY:
Edgar Rodriguez

DATE: 8/15/2024

SPOOL DRAWING NUMBER: CUJ11946 REV A 1-1/2" PUMP B LIQUID, FIXED END
 P&ID LINE #: 030
 CUJ11959 ITEM #: 5

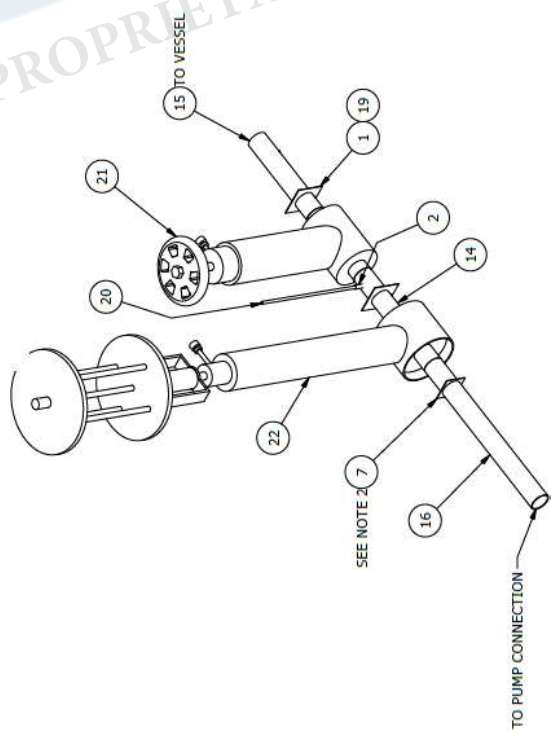

DIMENSIONAL CHECK			
ITEM#	DESIGN (IN)	ACTUAL (IN)	RESULT
14	5-1/2	5-5/8	Pass
15	10	15	Pass
16	18-1/4	18-3/8	Pass
TOTAL (Reference)	48-3/16	55-1/8	Pass
NOTES			

ITEM#	QTY	PART NUM	DESCRIPTION
22	-	-	1 VALVE, VACUUM, SEAL-OFF, 1/2"
21	-	-	1 VALVE, GLOBE, V/ EXT STEM, 1.5 IN. SS, BW, ACTUATED, VOGT W REV K05
20	-	-	1 VALVE, BELLOWS, V/ EXT STEM, 1.5 IN. SS, BW, MANUAL
19	-	-	1 TUBE, ROUND, SS, 1/4 O.D. X 0.049 WALL, CUT TO 8 LG, S4313, TP9316/316L, SMLS
18	-	-	1 AIR TIE WIRE, 0.02 00
17	-	-	1 TANK FIELD JUNIT, 1.5 X 4 X 6 IN. C4406
16	-	-	1 AIR STRONG, MULTIFEND CONTINUOUS WINDING, MEX021
15	-	-	1 PIPE, SS, 1-1/2 SCH 10, CUT TO 18-1/4 LG, SEAMLESS, S4312-316
14	-	-	1 PIPE, SS, 1-1/2 SCH 10, CUT TO 10 LG, SEAMLESS, S4312-316
13	-	-	1 NIPPLE, HALF, T.O.E., SS, 0.125 NPT SCH 80 X 1.5 LG, S4312, TP904
12	-	-	1 AIR CRYO-LITE, FIBERGLASS BLANKET, 1 THICK
11	-	-	1 TC TUBE GLAND
10	-	-	2 WELD ADAPTER, 4" IPS X 5" SCH5
9	-	-	1 ITEM DELETED
8	-	-	1 SPLIT JACKET LIQUID VAPOR HORIZONTAL
7	-	-	1 SPACER, 1-1/2" IPS X 3" SCH 5
6	-	-	1 SPLIT JACKET PUMP/LIQUID SEAL OFF
5	-	-	1 JACKET, STANDOFF, SAFETY
4	-	-	1 WELD ADAPTER 1-3/4" O.D. X 3/8" SCH 5
3	-	-	1 SPLIT JACKET ALK. VAPOR HORIZONTAL
2	-	-	1 ADAPTER, INNER LINE RELIEF
1	-	-	4 SPACER, 1-1/2" IPS X 4" SCH 5

INSPECTED BY:
 Robert Guajardo

DATE: 8/15/2024

VERIFIED BY:
 Edgar Rodriguez

DATE: 8/15/2024

SPOOL DRAWING NUMBER: CUJ11947 REVA; 1-1/2" PUMP B RETURN, FIXED END

P&ID LINE #: 031

CUJ11959 ITEM #: 6

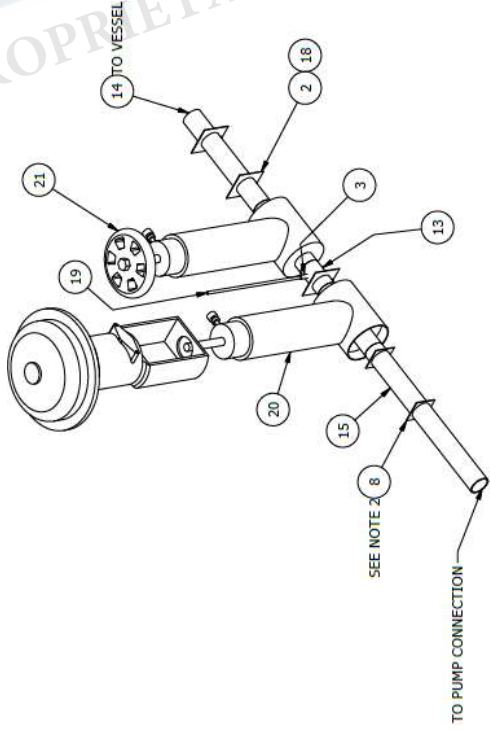

DIMENSIONAL CHECK			
ITEM#	DESIGN (IN)	ACTUAL (IN)	RESULT
13	3	3	Pass
14	12	17	Pass
15	18	18	Pass
TOTAL (Reference)	46	54-1/2	Pass

ITEM#	QTY	DESCRIPTION			
22	-	1 VALVE, VACUUM, SEAL-OFF, 1/2"			
21	-	1 VALVE, BELLOWS, V-EXT STEM, 1.5 IN. SS, BW, MANUAL			
20	-	1 VALVE, BELLOWS, V-EXT STEM, 1.5 IN. SS, BW, ACTUATED			
19	-	1 TUBE, ROUND, SS, 1/4 O.D. X 0.049 WALL, CUT TO 12 LG, SA312, TP316/316L, SMLS			
18	-	AIR TIE WIRE, 0.02 OD			
17	-	1 TRUNK FIELD JOINT, 1.5 X 4 X 6 IN, C-426			
16	-	AIR STRING, MULTI-END CONTINUOUS WELDING, ME3021			
15	-	1 PIPE, SS, 1-1/2 SCH 10, CUT TO 18 LG, SEAMLESS, SA312-316			
14	-	1 PIPE, SS, 1-1/2 SCH 10, CUT TO 12 LG, SEAMLESS, SA312-316			
13	-	1 PIPE, SS, 1-1/2 SCH 10, CUT TO 3 LG, SEAMLESS, SA312-316			
12	-	1 NIPPLE, HMF, T.O.E., SS, 0.125 IPT SCH 80 X 1.5 LG, SA312, TP304			
11	-	AIR CRYOLITE FIBERGLASS BLANKET, 1 THICK			
10	-	1 TC TUBE GUARD			
9	-	1 SPLIT JACKET LIQUID VAPOR HORIZONTAL			
8	-	2 SPACER, 1-1/2" IPS X 3" SCH 5			
7	-	1 SPLIT JACKET PUMP/LIQUID SEAL OFF			
6	-	1 JACKET, STAND-OFF, SAFETY			
5	-	1 SPLIT JACKET, PUMP HORIZONTAL			
4	-	1 WELD ADAPTER 1-3/4" O.D. X 3/8" SCH 5			
3	-	1 ADAPTER, INNER LINE RELIEF			
2	-	3 SPACER, 1-1/2" IPS X 4" SCH 5			
1	-	- DELETED ITEM			
ITEM#	NO.	SIZE	PART NUM.	QTY	DESCRIPTION

NOTES

INSPECTED BY:
Robert Guajardo

DATE: 8/15/2024

VERIFIED BY:
Edgar Rodriguez

DATE: 8/15/2024

SPOOL DRAWING NUMBER: CUJ11949 REV B 1-1/2" TOP FILL, FIXED END
 P&ID LINE #: 002
 CUJ11959 ITEM #: 8

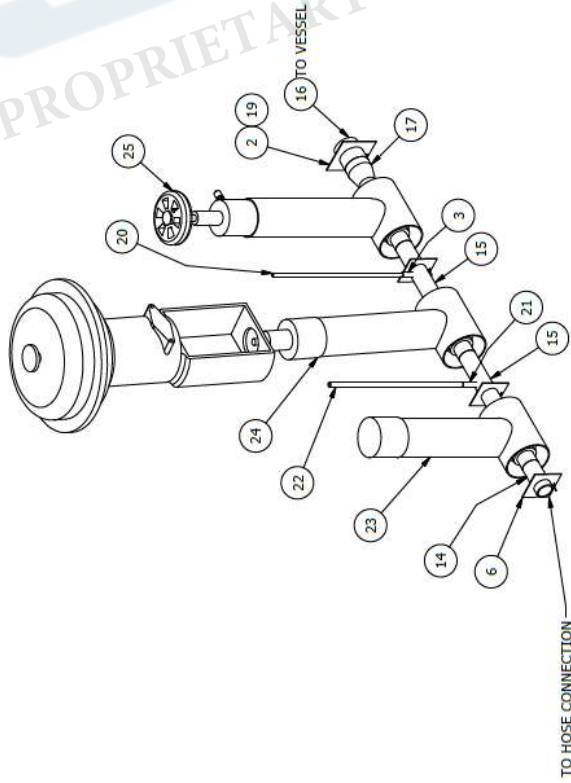

ITEM#	DESCRIPTION	QTY
26	1 VALVE, VACUUM, SEAL-OFF, 1/2"	
25	1 VALVE, BELLOW, EXT STEM, 1", BW, MANUAL	
24	1 VALVE, BELLOW, EXT STEM, 1", BW, ACTUATED	
23	1 VALVE, BELLOW, CHECK, LIFT, V, BELLOW, 1.0 IN, BW	
22	2 TUBE, ROUND, SS, 3/8 O.D. X 0.049 WALL, CUT TO 12 LG. SA213, TP316/316L, SMLS	
21	1 TUBE, ROUND, SS, 3/8 O.D. X 0.049 WALL, CUT TO 1-7/16 LG. SA213, TP316/316L, SMLS	
20	1 TUBE, ROUND, SS, 1/4 O.D. X 0.049 WALL, CUT TO 17 LG. SA213, TP316/316L, SMLS	
19	AIR TIE WIRE, 0.02 OD	
18	AIR STRING, MULTI-END CONTINUOUS WIRING, ME3021	
17	1 REDUCER, BW, CONCENTRIC, 1-1/2 X 1, SCH 10,	
16	1 PIPE, SS, 1-1/2 SCH 10, CUT TO 2 LG. SEAMLESS, SA312-316	
15	2 PIPE, SS, 1 SCH 10, CUT TO 5-1/2 LG. SEAMLESS, SA312-316	
14	1 PIPE, SS, 1 SCH 10, CUT TO 2-5/8 LG. SEAMLESS, SA312-316	
13	1 NIPPLE, HALF-TONE, SS, 0.125 NPT SCH 80 X 1.5 LG. SA312, TP304	
12	AIR CRYO-LITE, FIBERGLASS BLANKET, 1 THICK	
11	1 BAYONET, FEMALE, 1 X 3, Cup VIP	
10	1 TC TUBE GUARD	
9	1 SPLIT JACKET LIQUID VAPOR HORIZONTAL	
8	1 SPLIT JACKET LIQUID LIQUID SEAL OFF	
7	2 SPLIT JACKET HP PUMP RETURN	
6	3 SPACER, 1 IPS X 3 SCH 5	
5	2 JACKET, STANDOFF, SAFETY	
4	2 WELD ADAPTER, 1-3/4" O.D. X 3/8" SCH 5	
3	1 ADAPTER, INNER LINE RELIEF	
2	1 SPACER, 1-1/2" IPS X 4" SCH 5	
1	1 WELD ADAPTER, 3 IPS X 4 SCH 5	

DIMENSIONAL CHECK

ITEM#	DESIGN (IN)	ACTUAL (IN)	RESULT
14	2-5/8	3	Pass
15	5-1/2	5-1/2	Pass
16	2	7	Pass
TOTAL (Reference)	36-1/8	40-7/8	Pass

NOTES

INSPECTED BY:
Robert Guajardo

DATE: 8/15/2024

VERIFIED BY:
Edgar Rodriguez

DATE: 8/15/2024

SPOOL DRAWING NUMBER: CU11950 REVA 1" HP PUMP RETURN, FIXED END

P&ID LINE #: 001

CU11959 ITEM #: 9

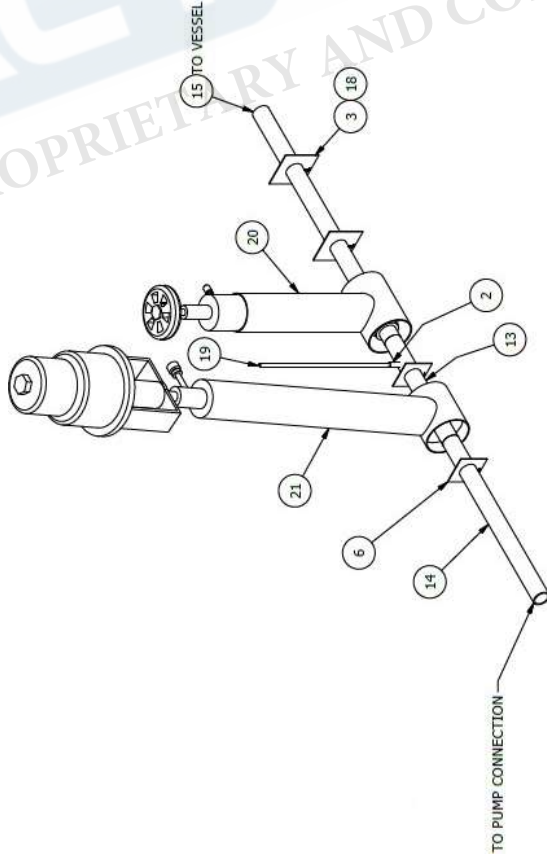

ITEM#	QTY.	DESCRIPTION
22	-	1 VALVE, VACUUM, SEAL-OFF, 1/2"
21	-	1 VALVE, BELLOWS, V1 EXT STEK, 1 IN, SS, BW, ACTUATED
20	-	1 VALVE, BELLOWS, EXT STEK, 1", BW, MANUAL
19	-	1 TUBE, ROUND, SS, 1/4" O.D. X 0.049 WALL, CUT TO 12 LG. SA312, TP316/316L, SMLS
18	-	A/R TIE WIRE, 0.02" OD
17	-	1 TANK FIELD JOINT, 1 X 3 X 6 IN, C1424
16	-	AIR STRING, MULTI-END CONTINUOUS, M2021
15	-	1 PIPE, SS, 1 SCH 10, CUT TO 18 LG, SEAMLESS, SA312-316
14	-	1 PIPE, SS, 1 SCH 10, CUT TO 16-1/2 LG, SEAMLESS, SA312-316
13	-	1 PIPE, SS, 1 SCH 10, CUT TO 5-1/2 LG, SEAMLESS, SA312-316
12	-	1 NIPPLE, HALF, T.O.E., SS, 0.125 NPT SCH 80 X 1.5 LG, SA312, TP304
11	-	A/R CRYO-LITE, FIBERGLASS BLANKET, 1 THICK
10	-	TC TUBE GUARD
9	-	1 SPLIT JACKET HP PUMP RETURN
8	-	1 SPLIT JACKET PUMP LIQUID SEAL OFF
7	-	1 SPLIT JACKET, HP PUMP RETURN
6	-	SPACER, 1 IPS X 3 SCH 5
5	-	1 JACKET, STANDOFF, SAFETY
4	-	1 WELD ADAPTER 1-3/4" O.D. X 3/8" SCH 5
3	-	SPACER, 1" IPS X 4" SCH 5
2	-	ADAPTER, INNER LINE RELIEF
1	-	1 WELD ADAPTER, 3" IPS X 4" SCH 5

DIMENSIONAL CHECK			
ITEM#	DESIGN (IN)	ACTUAL (IN)	RESULT
13	5-1/2	5-1/2	Pass
14	16-1/2	16-1/2	Pass
15	18	23	Pass
TOTAL (Reference)	51	56-5/8	Pass
NOTES			

INSPECTED BY:
Robert Guajardo

DATE:8/15/2024

VERIFIED BY:
Edgar Rodriguez

DATE:8/15/2024

SPOOL DRAWING NUMBER: CUJ11954 REV- 1" PB FEED, FLEX END
 P&ID LINE #: 070
 CUI11959 ITEM #: 12

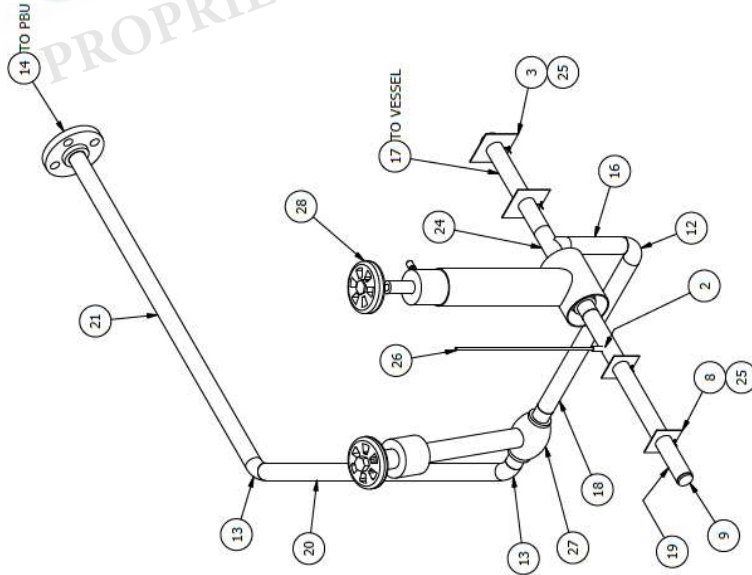

ITEM#	DESCRIPTION	QTY	DESCRIPTION
29	1 VALVE, VACUUM, SEAL-OFF, 1/2		
28	1 VALVE, GLOBE, MANUAL, BELLOWS, SEALED VACUUM JACKETED 1 IN, 1PS		
27	1 VALVE, GLOBE, MANUAL, BELLOWS, EXIT STEM, 1 BW, MANUAL		
26	1 TUBE, ROUND, SS, 1/4" O.D. X 0.049 WALL, CUT TO 13 LG, SA312, TP316/316L, SMLS		
25	1 AIR TIE WIRE, 304 SS, DIA. .002		
24	1 TEE, SS, BW, 1 SCH 10, SEAMLESS, SA312-316		
23	1 AIR STRING, MULTI-END CONTINUOUS RIVING, ME2021		
22	1 SPLIT JACKET, TEE RUN		
21	1 PIPE, SS, 1 SCH 10, CUT TO 33 LG, SEAMLESS, SA312-316		
20	1 PIPE, SS, 1 SCH 10, CUT TO 31-3/8 LG, SEAMLESS, SA312-316		
19	1 PIPE, SS, 1 SCH 10, CUT TO 17-5/8 LG, SEAMLESS, SA312-316		
18	1 PIPE, SS, 1 SCH 10, CUT TO 16 LG, SEAMLESS, SA312-316		
17	1 PIPE, SS, 1 SCH 10, CUT TO 10 LG, SEAMLESS, SA312-316		
16	1 PIPE, SS, 1 SCH 10, CUT TO 5-5/16 LG, SEAMLESS, SA312-316		
15	1 NIPPLE, HALF, T.O.E., SS, 0.125 NPT SCH 80 X 1.5 LG, SA312, TP304		
14	1 FLANGE, 1 REWM, 300#, ASTM SA182, 304		
13	2 ELB, WLD, BW, 45 DEG, LR		
12	1 ELB, SMLS, BW, 90 DEG, LR		
11	1 ELB, 90 DEG, LR, BW, SS, 1 SCH 10, SA403, WP316/316L		
10	1 AIR CRYO-LITE, FIBERGLASS BLANKET, 1 THICK		
9	1 CAP, PB FEED, 1		
8	2 SPACER, 1 IPS X 3 SCH 5		
7	1 SPLIT JACKET, PB FEED, TEE BRANCH		
6	2 WELD ADAPTER, 3 IPS X 1 SCH 5		
5	1 JACKET, STAND-OFF, SAFETY		
4	1 WELD ADAPTER 1-3/4" O.D. X 3/8" SCH 5		
3	2 SPACER, 1 IPS X 4 SCH 5		
2	1 ADAPTER, INNER LINE RELIEF		
1	1 WELD ADAPTER, 3 IPS X 4 SCH 5		



DIMENSIONAL CHECK			
ITEM#	DESIGN (IN)	ACTUAL (IN)	RESULT
16	5-5/16	5-5/8	Pass
17	10	10	Pass
19	17-5/8	17-1/2	Pass
TOTAL (Reference)	36-5/8	36-1/2	Pass
NOTES			

INSPECTED BY:
 Robert Guajardo
 DATE: 8/15/2024

VERIFIED BY:
 Edgar Rodriguez
 DATE: 8/15/2024





8 PHOTOGRAPHIC EVIDENCE OF THE INSPECTION

Description	Measurement Photo
Dwg # CU11944 Item # 14	
Dwg # CU11944 Item # 15	



NOTICE: THIS DOCUMENT EMBODIES CONFIDENTIAL PROPRIETARY INFORMATION OWNED BY APPLIED CRYO TECHNOLOGIES. NOTICE IS HEREBY GIVEN THAT ALL DESIGN, MANUFACTURING, REPRODUCTION, USE AND SALES RIGHTS REGARDING THE SAME ARE EXPRESSLY RESERVED TO APPLIED CRYO TECHNOLOGIES. THIS DOCUMENT IS SUBMITTED UNDER A CONFIDENTIAL RELATIONSHIP FOR A SPECIFIC PURPOSE AND THE RECIPIENT HEREOF BY ACCEPTING THIS DOCUMENT ASSUMES CUSTODY HEREOF AND AGREES NOT TO DISCLOSE THIS DOCUMENT OR ANY PORTION OF ITS CONTENTS TO ANY UNAUTHORIZED PERSON.

Description	Measurement Photo
<p>Dwg # CU11944 Item # 16</p>	
<p>Dwg # CU11944 Item # TOTAL</p>	



NOTICE: THIS DOCUMENT EMBODIES CONFIDENTIAL PROPRIETARY INFORMATION OWNED BY APPLIED CRYO TECHNOLOGIES. NOTICE IS HEREBY GIVEN THAT ALL DESIGN, MANUFACTURING, REPRODUCTION, USE AND SALES RIGHTS REGARDING THE SAME ARE EXPRESSLY RESERVED TO APPLIED CRYO TECHNOLOGIES. THIS DOCUMENT IS SUBMITTED UNDER A CONFIDENTIAL RELATIONSHIP FOR A SPECIFIC PURPOSE AND THE RECIPIENT HEREOF BY ACCEPTING THIS DOCUMENT ASSUMES CUSTODY HEREOF AND AGREES NOT TO DISCLOSE THIS DOCUMENT OR ANY PORTION OF ITS CONTENTS TO ANY UNAUTHORIZED PERSON.

Description	Measurement Photo
<p>Dwg # CU11945 Item # 13</p>	
<p>Dwg # CU11945 Item # 14</p>	



NOTICE: THIS DOCUMENT EMBODIES CONFIDENTIAL PROPRIETARY INFORMATION OWNED BY APPLIED CRYO TECHNOLOGIES. NOTICE IS HEREBY GIVEN THAT ALL DESIGN, MANUFACTURING, REPRODUCTION, USE AND SALES RIGHTS REGARDING THE SAME ARE EXPRESSLY RESERVED TO APPLIED CRYO TECHNOLOGIES. THIS DOCUMENT IS SUBMITTED UNDER A CONFIDENTIAL RELATIONSHIP FOR A SPECIFIC PURPOSE AND THE RECIPIENT HEREOF BY ACCEPTING THIS DOCUMENT ASSUMES CUSTODY HEREOF AND AGREES NOT TO DISCLOSE THIS DOCUMENT OR ANY PORTION OF ITS CONTENTS TO ANY UNAUTHORIZED PERSON.

Description	Measurement Photo
<p>Dwg # CU11945 Item # 15</p>	
<p>Dwg # CU11945 Item # TOTAL</p>	



NOTICE: THIS DOCUMENT EMBODIES CONFIDENTIAL PROPRIETARY INFORMATION OWNED BY APPLIED CRYO TECHNOLOGIES. NOTICE IS HEREBY GIVEN THAT ALL DESIGN, MANUFACTURING, REPRODUCTION, USE AND SALES RIGHTS REGARDING THE SAME ARE EXPRESSLY RESERVED TO APPLIED CRYO TECHNOLOGIES. THIS DOCUMENT IS SUBMITTED UNDER A CONFIDENTIAL RELATIONSHIP FOR A SPECIFIC PURPOSE AND THE RECIPIENT HEREOF BY ACCEPTING THIS DOCUMENT ASSUMES CUSTODY HEREOF AND AGREES NOT TO DISCLOSE THIS DOCUMENT OR ANY PORTION OF ITS CONTENTS TO ANY UNAUTHORIZED PERSON.

Description	Measurement Photo
<p>Dwg # CU11946 Item # 14</p>	
<p>Dwg # CU11946 Item # 15</p>	



NOTICE: THIS DOCUMENT EMBODIES CONFIDENTIAL PROPRIETARY INFORMATION OWNED BY APPLIED CRYO TECHNOLOGIES. NOTICE IS HEREBY GIVEN THAT ALL DESIGN, MANUFACTURING, REPRODUCTION, USE AND SALES RIGHTS REGARDING THE SAME ARE EXPRESSLY RESERVED TO APPLIED CRYO TECHNOLOGIES. THIS DOCUMENT IS SUBMITTED UNDER A CONFIDENTIAL RELATIONSHIP FOR A SPECIFIC PURPOSE AND THE RECIPIENT HEREOF BY ACCEPTING THIS DOCUMENT ASSUMES CUSTODY HEREOF AND AGREES NOT TO DISCLOSE THIS DOCUMENT OR ANY PORTION OF ITS CONTENTS TO ANY UNAUTHORIZED PERSON.

Description	Measurement Photo
<p>Dwg # CU11946 Item # 16</p>	
<p>Dwg # CU11946 Item # TOTAL</p>	



NOTICE: THIS DOCUMENT EMBODIES CONFIDENTIAL PROPRIETARY INFORMATION OWNED BY APPLIED CRYO TECHNOLOGIES. NOTICE IS HEREBY GIVEN THAT ALL DESIGN, MANUFACTURING, REPRODUCTION, USE AND SALES RIGHTS REGARDING THE SAME ARE EXPRESSLY RESERVED TO APPLIED CRYO TECHNOLOGIES. THIS DOCUMENT IS SUBMITTED UNDER A CONFIDENTIAL RELATIONSHIP FOR A SPECIFIC PURPOSE AND THE RECIPIENT HEREOF BY ACCEPTING THIS DOCUMENT ASSUMES CUSTODY HEREOF AND AGREES NOT TO DISCLOSE THIS DOCUMENT OR ANY PORTION OF ITS CONTENTS TO ANY UNAUTHORIZED PERSON.

Description	Measurement Photo
<p>Dwg # CU11947 Item # 13</p>	
<p>Dwg # CU11947 Item # 14</p>	



NOTICE: THIS DOCUMENT EMBODIES CONFIDENTIAL PROPRIETARY INFORMATION OWNED BY APPLIED CRYO TECHNOLOGIES. NOTICE IS HEREBY GIVEN THAT ALL DESIGN, MANUFACTURING, REPRODUCTION, USE AND SALES RIGHTS REGARDING THE SAME ARE EXPRESSLY RESERVED TO APPLIED CRYO TECHNOLOGIES. THIS DOCUMENT IS SUBMITTED UNDER A CONFIDENTIAL RELATIONSHIP FOR A SPECIFIC PURPOSE AND THE RECIPIENT HEREOF BY ACCEPTING THIS DOCUMENT ASSUMES CUSTODY HEREOF AND AGREES NOT TO DISCLOSE THIS DOCUMENT OR ANY PORTION OF ITS CONTENTS TO ANY UNAUTHORIZED PERSON.

Description	Measurement Photo
<p>Dwg # CU11947 Item # 15</p>	
<p>Dwg # CU11947 Item # TOTAL</p>	



NOTICE: THIS DOCUMENT EMBODIES CONFIDENTIAL PROPRIETARY INFORMATION OWNED BY APPLIED CRYO TECHNOLOGIES. NOTICE IS HEREBY GIVEN THAT ALL DESIGN, MANUFACTURING, REPRODUCTION, USE AND SALES RIGHTS REGARDING THE SAME ARE EXPRESSLY RESERVED TO APPLIED CRYO TECHNOLOGIES. THIS DOCUMENT IS SUBMITTED UNDER A CONFIDENTIAL RELATIONSHIP FOR A SPECIFIC PURPOSE AND THE RECIPIENT HEREOF BY ACCEPTING THIS DOCUMENT ASSUMES CUSTODY HEREOF AND AGREES NOT TO DISCLOSE THIS DOCUMENT OR ANY PORTION OF ITS CONTENTS TO ANY UNAUTHORIZED PERSON.

Description	Measurement Photo
<p>Dwg # CU11949 Item # 14</p>	
<p>Dwg # CU11949 Item # 15</p>	



NOTICE: THIS DOCUMENT EMBODIES CONFIDENTIAL PROPRIETARY INFORMATION OWNED BY APPLIED CRYO TECHNOLOGIES. NOTICE IS HEREBY GIVEN THAT ALL DESIGN, MANUFACTURING, REPRODUCTION, USE AND SALES RIGHTS REGARDING THE SAME ARE EXPRESSLY RESERVED TO APPLIED CRYO TECHNOLOGIES. THIS DOCUMENT IS SUBMITTED UNDER A CONFIDENTIAL RELATIONSHIP FOR A SPECIFIC PURPOSE AND THE RECIPIENT HEREOF BY ACCEPTING THIS DOCUMENT ASSUMES CUSTODY HEREOF AND AGREES NOT TO DISCLOSE THIS DOCUMENT OR ANY PORTION OF ITS CONTENTS TO ANY UNAUTHORIZED PERSON.

Description	Measurement Photo
<p>Dwg # CU11949 Item # 16</p>	
<p>Dwg # CU11949 Item # TOTAL</p>	



NOTICE: THIS DOCUMENT EMBODIES CONFIDENTIAL PROPRIETARY INFORMATION OWNED BY APPLIED CRYO TECHNOLOGIES. NOTICE IS HEREBY GIVEN THAT ALL DESIGN, MANUFACTURING, REPRODUCTION, USE AND SALES RIGHTS REGARDING THE SAME ARE EXPRESSLY RESERVED TO APPLIED CRYO TECHNOLOGIES. THIS DOCUMENT IS SUBMITTED UNDER A CONFIDENTIAL RELATIONSHIP FOR A SPECIFIC PURPOSE AND THE RECIPIENT HEREOF BY ACCEPTING THIS DOCUMENT ASSUMES CUSTODY HEREOF AND AGREES NOT TO DISCLOSE THIS DOCUMENT OR ANY PORTION OF ITS CONTENTS TO ANY UNAUTHORIZED PERSON.

Description	Measurement Photo
<p>Dwg # CU11950 Item # 13</p>	
<p>Dwg # CU11950 Item # 14</p>	



NOTICE: THIS DOCUMENT EMBODIES CONFIDENTIAL PROPRIETARY INFORMATION OWNED BY APPLIED CRYO TECHNOLOGIES. NOTICE IS HEREBY GIVEN THAT ALL DESIGN, MANUFACTURING, REPRODUCTION, USE AND SALES RIGHTS REGARDING THE SAME ARE EXPRESSLY RESERVED TO APPLIED CRYO TECHNOLOGIES. THIS DOCUMENT IS SUBMITTED UNDER A CONFIDENTIAL RELATIONSHIP FOR A SPECIFIC PURPOSE AND THE RECIPIENT HEREOF BY ACCEPTING THIS DOCUMENT ASSUMES CUSTODY HEREOF AND AGREES NOT TO DISCLOSE THIS DOCUMENT OR ANY PORTION OF ITS CONTENTS TO ANY UNAUTHORIZED PERSON.

Description	Measurement Photo
<p>Dwg # CU11950 Item # 15</p>	
<p>Dwg # CU11950 Item # TOTAL</p>	

NOTICE: THIS DOCUMENT EMBODIES CONFIDENTIAL PROPRIETARY INFORMATION OWNED BY APPLIED CRYO TECHNOLOGIES. NOTICE IS HEREBY GIVEN THAT ALL DESIGN, MANUFACTURING, REPRODUCTION, USE AND SALES RIGHTS REGARDING THE SAME ARE EXPRESSLY RESERVED TO APPLIED CRYO TECHNOLOGIES. THIS DOCUMENT IS SUBMITTED UNDER A CONFIDENTIAL RELATIONSHIP FOR A SPECIFIC PURPOSE AND THE RECIPIENT HEREOF BY ACCEPTING THIS DOCUMENT ASSUMES CUSTODY HEREOF AND AGREES NOT TO DISCLOSE THIS DOCUMENT OR ANY PORTION OF ITS CONTENTS TO ANY UNAUTHORIZED PERSON.

Description	Measurement Photo
<p>Dwg # CU11954 Item # 16</p>	
<p>Dwg # CU11954 Item # 17</p>	

NOTICE: THIS DOCUMENT EMBODIES CONFIDENTIAL PROPRIETARY INFORMATION OWNED BY APPLIED CRYO TECHNOLOGIES. NOTICE IS HEREBY GIVEN THAT ALL DESIGN, MANUFACTURING, REPRODUCTION, USE AND SALES RIGHTS REGARDING THE SAME ARE EXPRESSLY RESERVED TO APPLIED CRYO TECHNOLOGIES. THIS DOCUMENT IS SUBMITTED UNDER A CONFIDENTIAL RELATIONSHIP FOR A SPECIFIC PURPOSE AND THE RECIPIENT HEREOF BY ACCEPTING THIS DOCUMENT ASSUMES CUSTODY HEREOF AND AGREES NOT TO DISCLOSE THIS DOCUMENT OR ANY PORTION OF ITS CONTENTS TO ANY UNAUTHORIZED PERSON.

Description	Measurement Photo
<p>Dwg # CU11954 Item # 19</p>	
<p>Dwg # CU11954 Item # TOTAL</p>	

NOTICE: THIS DOCUMENT EMBODIES CONFIDENTIAL PROPRIETARY INFORMATION OWNED BY APPLIED CRYO TECHNOLOGIES. NOTICE IS HEREBY GIVEN THAT ALL DESIGN, MANUFACTURING, REPRODUCTION, USE AND SALES RIGHTS REGARDING THE SAME ARE EXPRESSLY RESERVED TO APPLIED CRYO TECHNOLOGIES. THIS DOCUMENT IS SUBMITTED UNDER A CONFIDENTIAL RELATIONSHIP FOR A SPECIFIC PURPOSE AND THE RECIPIENT HEREOF BY ACCEPTING THIS DOCUMENT ASSUMES CUSTODY HEREOF AND AGREES NOT TO DISCLOSE THIS DOCUMENT OR ANY PORTION OF ITS CONTENTS TO ANY UNAUTHORIZED PERSON.

DOC-009-0028 REVA; EXTERNAL PIPE DIMENSIONAL CHECK PHOTOGRAPHIC EVIDENCE REPORT

Final Audit Report

2024-01-22

Created:	2024-01-22
By:	Ethan Anderson (etanderson@plugpower.com)
Status:	Signed
Transaction ID:	CBJCHBCAABAAYwF4XUTEruHq9n3Gja06P5QQsfjR1SCU

"DOC-009-0028 REVA; EXTERNAL PIPE DIMENSIONAL CHECK PHOTOGRAPHIC EVIDENCE REPORT" History

 Document created by Ethan Anderson (etanderson@plugpower.com)
2024-01-22 - 3:57:55 PM GMT

 Document emailed to Ethan Anderson (etanderson@plugpower.com) for signature
2024-01-22 - 3:58:01 PM GMT

 Document e-signed by Ethan Anderson (etanderson@plugpower.com)
E-signature obtained using URL retrieved through the Adobe Acrobat Sign API
Signature Date: 2024-01-22 - 3:58:20 PM GMT - Time Source: server

 Document emailed to Nidhi Shah (nshah@plugpower.com) for signature
2024-01-22 - 3:58:21 PM GMT

 Email viewed by Nidhi Shah (nshah@plugpower.com)
2024-01-22 - 4:31:47 PM GMT

 Document e-signed by Nidhi Shah (nshah@plugpower.com)
Signature Date: 2024-01-22 - 4:32:01 PM GMT - Time Source: server

 Document emailed to Jesse Lundy (jlundy@plugpower.com) for signature
2024-01-22 - 4:32:03 PM GMT

 Email viewed by Jesse Lundy (jlundy@plugpower.com)
2024-01-22 - 4:34:17 PM GMT

 Document e-signed by Jesse Lundy (jlundy@plugpower.com)
Signature Date: 2024-01-22 - 4:34:29 PM GMT - Time Source: server

✔ Agreement completed.

2024-01-22 - 4:34:29 PM GMT

ACT Applied Cryo
TECHNOLOGIES
PROPRIETARY AND CONFIDENTIAL

LH2HT-168013 - EXTERNAL PIPE DIMENSIONAL CHECK PHOTOGRAPHIC EVIDENCE REPORT

Final Audit Report

2024-08-31

Created:	2024-08-31
By:	Edgar Rodriguez (erodriguez@plugpower.com)
Status:	Signed
Transaction ID:	CBJCHBCAABAAeQUqkTHrVvbH9mTS08vQtMiiHr0EJvew

"LH2HT-168013 - EXTERNAL PIPE DIMENSIONAL CHECK PHOTOGRAPHIC EVIDENCE REPORT" History

 Document created by Edgar Rodriguez (erodriguez@plugpower.com)
2024-08-31 - 10:54:09 PM GMT

 Document emailed to Jesse Lundy (jlundy@plugpower.com) for signature
2024-08-31 - 10:54:23 PM GMT

 Document emailed to Jeonghan Yun (jh.yun@nikkisoceig.com) for signature
2024-08-31 - 10:54:23 PM GMT

 Document emailed to Jung Hae Song (jhs30711@kgs.or.kr) for signature
2024-08-31 - 10:54:23 PM GMT

 Document emailed to Lee Jun Gyu (re_ps1@kgs.or.kr) for signature
2024-08-31 - 10:54:23 PM GMT

 Email viewed by Jesse Lundy (jlundy@plugpower.com)
2024-08-31 - 10:54:40 PM GMT

 Document e-signed by Jesse Lundy (jlundy@plugpower.com)
Signature Date: 2024-08-31 - 10:54:50 PM GMT - Time Source: server

 Email viewed by Jeonghan Yun (jh.yun@nikkisoceig.com)
2024-08-31 - 10:55:11 PM GMT

 Document e-signed by Jeonghan Yun (jh.yun@nikkisoceig.com)
Signature Date: 2024-08-31 - 10:55:42 PM GMT - Time Source: server

 Email viewed by Jung Hae Song (jhs30711@kgs.or.kr)

2024-08-31 - 10:55:42 PM GMT

 Document e-signed by Jung Hae Song (jhs30711@kgs.or.kr)

Signature Date: 2024-08-31 - 10:56:36 PM GMT - Time Source: server

 Email viewed by Lee Jun Gyu (re_ps1@kgs.or.kr)

2024-08-31 - 10:56:54 PM GMT

 Signer Lee Jun Gyu (re_ps1@kgs.or.kr) entered name at signing as Jun-gyu Lee

2024-08-31 - 10:57:19 PM GMT

 Document e-signed by Jun-gyu Lee (re_ps1@kgs.or.kr)

Signature Date: 2024-08-31 - 10:57:21 PM GMT - Time Source: server

 Agreement completed.

2024-08-31 - 10:57:21 PM GMT

 **Applied Cryo**
TECHNOLOGIES
PROPRIETARY AND CONFIDENTIAL